

- P1** * 3-5/8" x 25 GA. min. Met. Framing 16" o.c.
 * Partition Framing Hgt. to underside of roof deck above w/ Deflection Runner.
 * 5/8" Gyp. Bd. both sides (5/8" M.R. Gyp. Bd. if sched. on Fin. Sched.).
 * Gyp. Bd. Full Hgt. one side, 6" min. abv. Clg. Hgt. (see Fin. Sched.) other side.
 * Total Partition Thk. 4-7/8" (non-firerated).
- P2** * 3-5/8" x 25 GA. min. Met. Framing 16" o.c. adj. to wall substrate w/ 1/2" nominal clear space (gap).
 * Partition Framing Hgt. to underside of roof deck above w/ deflection runner.
 * 5/8" Gyp. Bd. one side (5/8" M.R. Gyp. Bd., where sched. on Fin. Sched.).
 * Gyp. Bd. Fin. to 6" min. hgt. above adj. clg. hgt.
 * Total Partition Thk. 4-3/4" from face of adj. wall surface (non-firerated)
- P3** * 3-5/8" x 25 GA. min. Met. Framing 16" o.c. adj. to wall substrate w/ 2" nominal clear space (gap).
 * Partition Framing Hgt. to underside of roof deck above w/ deflection runner.
 * 5/8" Gyp. Bd. one side (5/8" M.R. Gyp. Bd., where sched. on Fin. Sched.).
 * Gyp. Bd. Fin. to 6" min. hgt. above adj. clg. hgt.
 * Total Partition Thk. 6-1/4" from face of adj. wall surface (non-firerated)
- P4** * 7/8" x 25 GA. min. Met. Furring channels 16" o.c. on existing CMU wall.
 * Partition Framing Hgt. to top of existing CMU wall.
 * 5/8" Gyp. Bd. one side (5/8" M.R. Gyp. Bd., where sched. on Fin. Sched.).
 * Gyp. Bd. Fin. full height.
 * Total Partition Thk. 1-1/2" from face of adj. wall surface (non-firerated)
- P5** * 3-5/8" x 25 GA. min. Met. Framing 16" o.c.
 * Partition Framing Hgt. to underside of roof deck above w/ Deflection Runner.
 * 5/8" Gyp. Bd. both sides (5/8" M.R. Gyp. Bd. if sched. on Fin. Sched.).
 * Gyp. Bd. Full Hgt. both sides.
 * Total Partition Thk. 4-7/8" (non-firerated).
- P6** * 6" x 20 GA. min. Met. Framing 16" o.c. adj. to wall substrate w/ 1" nominal clear space (gap).
 * Align face of Met. Framing w/ face of existing Columns.
 * Partition Framing Hgt. to underside of roof deck above w/ deflection runner.
 * Blocking. Ref. 11/A8.2
 * 5/8" Gyp. Bd. one side (5/8" M.R. Gyp. Bd., where sched. on Fin. Sched.).
 * Total Partition Thk. 7-5/8" from face of adj. wall surface (non-firerated)
- P7** * 3-5/8" x 25 GA. min. Met. Framing 16" o.c.
 * Partition Framing Hgt. to 10'-0" a.f.f.
 * 5/8" Gyp. Bd. one side.
 * Total Partition Thk. 4-1/4" (non-firerated).

| | |
|------------------------|----------------|
| PARTITION TYPES | 20 |
| REF.: | SOURCE: N.T.S. |

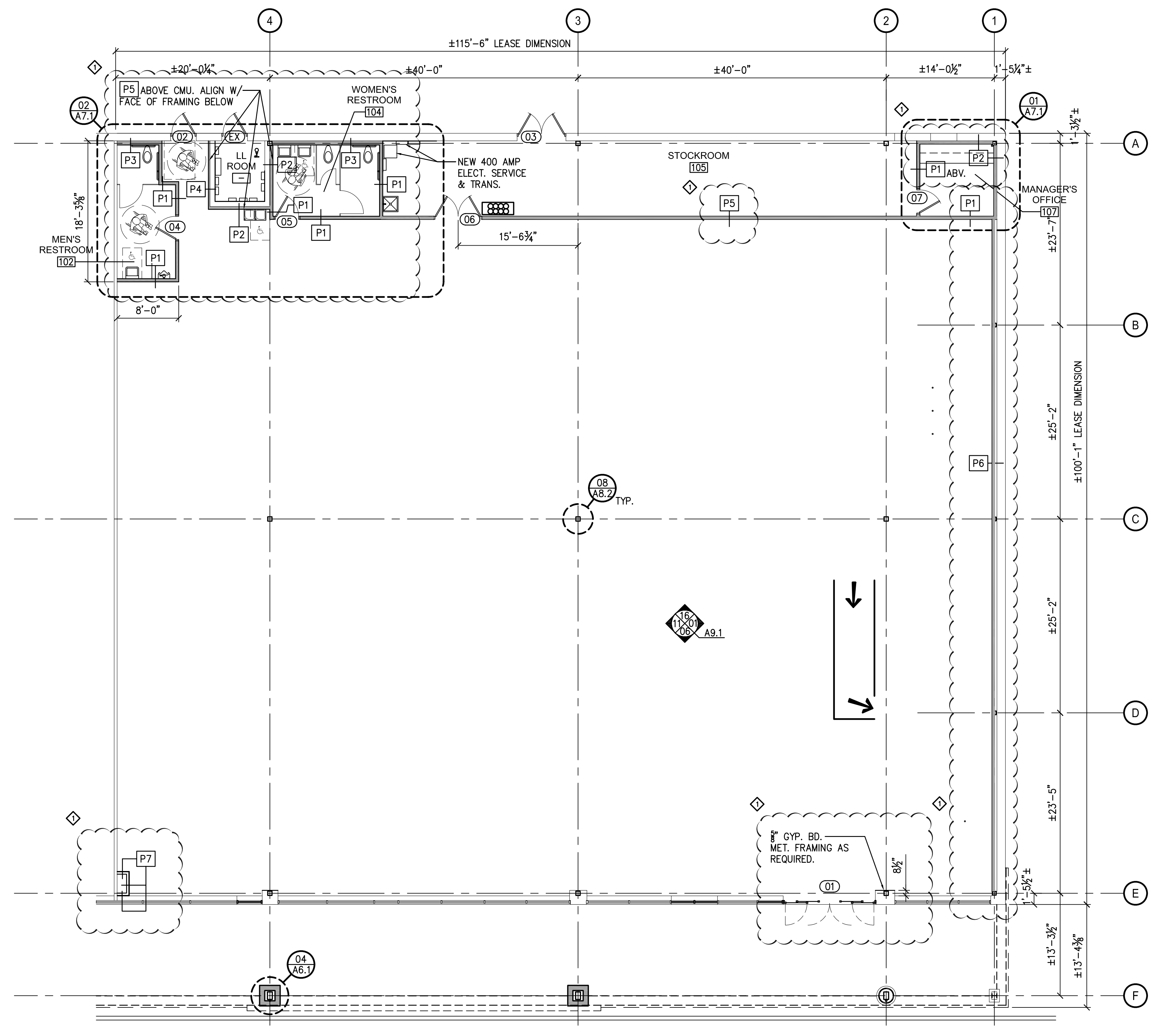

CONSTRUCTION NOTES:

1. INSPECT THE CONDITION OF EXISTING DEMISING PARTITIONS & EXTERIOR GLAZING WALLS AND PROVIDE FULL HEIGHT & FINISHED PARTITION TO UNDERSIDE OF DECK AS REQUIRED. PATCH AND REPAIR TO ACHIEVE OR MAINTAIN REQ'D FIRE RATING - TAPE AND SPACKLE TO PREPARE FOR FINISHES
2. UPON POSSESSION OF THE PREMISES, DIMENSIONS OF SPACE SHALL BE VERIFIED. G.C. SHALL SUBMIT NOTED DISCREPANCIES TO THE TENANT PROJECT MANAGER AND REQUIRED VENDORS WITHIN 3 DAYS OF THE START OF CONSTRUCTION.
3. WHEN RE-USING EXISTING DRYWALL CONSTRUCTION, PATCH AND REPAIR WALLS AS NECESSARY TO ENSURE REQUIRED RATING. PATCH ALL VOIDS INCLUDING DECK FLUTES WITH NON-COMBUSTIBLE MATERIALS.
4. ALL SLAB PENETRATIONS MUST BE APPROVED IN WRITING BY THE OWNER PRIOR TO THE COMMENCEMENT OF WORK. GENERAL CONTRACTOR SHALL ENSURE THAT ALL SLAB PENETRATIONS WITHIN THE TENANTS PREMISES ARE PROPERLY SEALED AND REMAIN WATERTIGHT TO PREVENT POSSIBLE DAMAGE.
5. ALL DIMENSIONS ON PLAN FOR NEW INTERIOR WALL LAYOUTS ARE FROM FINISHED WALL TO FINISHED WALL UNLESS NOTED OTHERWISE.
6. PATCH & FIRE STOP G.W.B. PARTITIONS AS REQ'D BY LOCAL CODES.
7. WRITTEN DIMENSIONS TAKE PRECEDENCE OVER SCALE ON THE CONSTRUCTION DOCUMENTS. DO NOT SCALE.
8. APPROVED FIRE EXTINGUISHERS SHALL BE INSTALLED AS REQUIRED BY LOCAL AUTHORITY.
9. ALL PENETRATIONS OF FIRE RESISTIVE FLOORS OR SHAFT WALLS SHALL BE PROTECTED BY MATERIALS AND INSTALLATION DETAILS THAT CONFORM TO UL STANDARDS FOR THROUGH PENETRATIONS FIRE STOP SYSTEMS. THE CONTRACTOR SHALL SUBMIT SHOP DRAWING DETAILS WHICH SHOW COMPLETE CONFORMANCE TO THE UL LISTING TO THE ARCHITECT. SUCH DRAWINGS SHALL BE AVAILABLE TO ANY CITY INSPECTORS. THE DRAWINGS SHALL BE SPECIFIC FOR EACH PENETRATION WITH ALL VARIABLES DEFINED.
10. PROVIDE DIAGONAL BRACING TO STRUCTURE ABOVE ALL DOORS, GLAZING HEADS AND JAMBS AS REQUIRED TO MAKE ASSEMBLY RIGID.
11. PROVIDE & INSTALL BROWN PAPER COVERING APPLIED TO THE STOREFRONT GLAZING DURING MERCHANDISING. VERIFY REQUIREMENTS WITH TENANT PROJECT MANAGER.

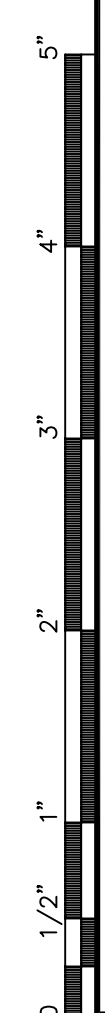

Robert J. Ignarri AIA
 NJ A110821
 David N. Lummis AIA
 NJ A10824

Ignarri Lummis
 ARCHITECTS
 601 Chapel Avenue East • Cherry Hill, New Jersey 08034
 P 856.428.8877 F 856.428.6375 ignarrilummis.com

National Realty & Development Corp.
 NATIONAL REALTY & DEVELOPMENT CORP.
 3 MANHATTANVILLE ROAD
 PURCHASE, NY 10577-5117

Party City
 RELOCATION TENANT IMPROVEMENTS
 2200 BURLINGTON-MT. HOLLY ROAD
 BURLINGTON TWP., NJ 08016

| | |
|--------------------|----------|
| DISTRIBUTION: | DATE: |
| TENANT REVIEW | 01/13/09 |
| 100% COMPLETION | 11/16/10 |
| PERMIT SUBMISSION | 12/22/10 |
| Const. Bulletin #1 | 02/01/11 |

| | |
|-----------------|----------|
| ARCH. PROJECT # | |
| 7827.00 | |
| DRAWN: | CHECKED: |
| TWH / ACH | FYL |

CONTRACTOR(S) SHALL VERIFY EXISTING CONDITIONS AND CORRELATE DIMENSIONS PRIOR TO PROVIDING THE WORK DETAILED IN THESE DRAWINGS, AND SHALL PROMPTLY NOTIFY THE ARCHITECT OF ANY DISCREPANCIES.

COPYRIGHT IGNARRI LUMMIS ARCHITECTS LLP. UNAUTHORIZED REPRODUCTION OR OTHER USE OF THIS DRAWING IS PROHIBITED.

| |
|-----------------------|
| DRAWING TITLE: |
| FLOOR PLAN |
| A2.1 |